



Real Fires Classic Installation Instructions

Model 1500

Installation Into Timber Framing And New Masonry Block Construction

New Masonry Block

The following instructions are for installation into timber frame. The method of installation is the same for New Masonry Block. **See Masonry Block Drawing**

Ventilation

Ventilation to the room that houses the fire must meet the requirements of NZS5261.

Framing Details

Prior to installation, timber framing needs to be provided to suit the selected Real Fire. **See installation drawing**

Hearth

A non combustible Hearth must be provided in front of the Real Fire unless the flooring in front of the fire is non combustible. The minimum size is 300mm out from the fire and 150mm each side wider than the fire.

Height of fire from floor

It is important to confirm the height the fire is to be installed from the floor level. This is usually the hearth height. For example if the hearth is 100mm high then the fire needs to be installed 100mm high. (**note** - some elevated installations specify the fire higher than the hearth). Once the height is confirmed a platform needs to be built to support the firebox. The platform can be of timber construction. It needs to be sturdy and level.

Gas supply

A suitable gas supply needs to be provided at the right hand rear corner of the timber frame cavity. The pipe sizing should be calculated to supply gas to suit the megajoule rating of the fire. See rating chart. The gas supply should be reduced down to 10mm copper pipe at the fireplace location and left with a coil of approx 1 metre to feed into the firebox.

Gas Rate Chart

Model	LPG	Natural Gas
650	36 MJ/h	38 MJ/h
700	34 MJ/h	39 MJ/h
800	42 MJ/h	40 MJ/h
900	50 MJ/h	40 MJ/h
1000	51 MJ/h	47 MJ/h
1200	65 MJ/h	53 MJ/h
1500	65 MJ/h	51 MJ/h

Electrical supply

An electrical supply will required for fires fitted with the optional Fan Set or Electric On/Off. This should be by means of a wall switch provided by an electrician and located near the fireplace. Not inside the fireplace cavity.

See installation drawing for preferred location of switch.

Insulation Kit & Timber Clearance

When installed into timber framing the Real Fire must be installed with an insulation kit. This must be ordered with the fire and fitted in the factory by Real Fires. The insulation kit allows the firebox to be installed with minimal timber clearances: 10mm clearance on sides of firebox and 25mm clearance from rear and top of firebox.

The timber clearance from the twin wall flue is also 25mm. There is no requirement for any additional fireproof materials within the fireplace cavity providing minimum clearances are allowed.

Recessed firebox installation

Standard wall linings are not suitable for recessed installation

Please contact Real Fires for advice prior to installation

Flue requirements

The minimum flue height is 2.4 metres. The flue cowl should be no lower than 900mm vertically from the roof line and a 2 metre horizontal clearance from any part of the building **see cowl clearance drawing**.

Flue and Cowl Size

Model	Flue	Cowl Size
Real Fire 650	150mm inner flue/ 200mm outer flue	150/200 Cowl
Real Fire 700	150mm inner flue/ 200mm outer flue	150/200 Cowl
Real Fire 800	200mm inner flue/ 250mm outer flue	200/250 Cowl
Real Fire 900	200mm inner flue/ 250mm outer flue	200/250 Cowl
Real Fire 1000	200mm inner flue/ 250mm outer flue	200/250 Cowl
Real Fire 1200	250mm inner flue/ 300mm outer flue	250/300 Cowl

The Real Fire 1500 has Two Flues

There are two flue spigots on top of the insulation kit. Two 150mm/200mm x 1200mm long sections of flue are connected to the spigots. The two flues are then connected to a special Y piece, this is a transition to join the two flues into one. From the Y piece a single 250/300mm flue kit is used with a 250/300 cowl.

Installation instructions

Firstly the firebox and flue are installed and then the burner is installed. The burner may be installed at a later date when all the construction work is complete and the hearth is in place.

The firebox is placed on the platform provided and the gas pipe is pushed through the hole at the right hand rear of the firebox (RH from the front of the fire).

This pipe is to be connected to the burner but may be left sealed if the burner is to be installed later. Leave enough pipe to connect the burner. Once the firebox is in place ensure it is level. Usually the firebox is positioned centrally and so that the flange around the firebox opening is left forward of the timber framing by 10mm, this is to allow for giboard to be fixed behind the flange.

From the positioned firebox the flue can be assembled. The flue is in 1200mm lengths with both inner and outer flue. Each flue length has a crimped end to join tightly to the next length. Each joint must be securely fixed by at least three stainless steel rivets. The firebox has a spigot for the flue to locate over. **The flue lengths should be installed with the crimped end facing up.**

The Firebox and flue should be secured by fixing with seismic strapping and/or brackets to framing. Flue bends are available from Real Fires if the flue needs to be offset. Appropriate weatherproof roof flashing/ chimney capping must be used to comply with NZS 5261.

Once the installation of the firebox and flue is complete, the building work around the fireplace can continue. A timber cross frame is usually fixed above the firebox for gib fixing. This must be at least 25mm from the firebox.

The firebox will have two electrical leads from the rear of the firebox. All fireboxes are pre wired for the electrical options, Fan and Electric On/Off.

The leads are approximately 1.2m long and are intended to be connected by an electrician to a switch positioned facing the room preferably on the left hand side of the fireplace cavity. **See installation drawing.**

(Please ensure the electrical leads are not left behind the firebox and overlooked. It is difficult to gain access once the gibboard is fixed)

Timber surround

If a timber surround is to be fitted, ensure it complies with Real Fires minimum clearance dimensions.

See installation drawing

Installation instructions - Burner into firebox

The burner is supplied boxed complete with, firebox reflectors, grate, ash cover, vermiculite, logs, & coals.

To make the gas connection, place the burner in the firebox so that the back of the burner is touching the back of the firebox and is positioned central. The gas pipe should be bent into position and marked for cutting.

Remove the burner cut the pipe and make a flare connection.

Re fit the burner into the firebox ensuring it is touching the back of the firebox. Connect the gas pipe. Test for soundness. Remove plastic protective film from side reflectors. Position reflectors each side of firebox and fit the front grate onto the brackets at the front of the burner. The Grate holds the reflectors in place.

Natural Gas burner

Fill the burner tray with the vermiculite supplied ensuring the burner tube is completely covered. Lay logs and coals on top of the vermiculite as shown in the **log/coal layout drawing**. Note that the shelf at the back of the burner is also used. **Do not place logs or coals close to the pilot.** It is important that the coals are not too tightly placed as this will affect heat output. The flame picture and radiant glow is better when there is good spacing between the coals.

L.P.G. Burner

The L.P.G. burner is a flat steel burner. This burner is supplied with a bag of coarse vermiculite, spread this thinly (5 to 10mm) over the surface of the burner. **Follow instructions for coal placement as with Natural Gas burner.**

Optional Electric On/Off option

If the burner is fitted with an electric On/Off solenoid, there will be an electrical lead with a connector plug in the base of the fire. The plug connects to the solenoid. The electrical lead should be wired to a wall switch by an electrician. The burner will not operate without electrical supply to the solenoid on.

Commissioning of the Burner

Turn the control knob to ignite the pilot, this may take several attempts until air has been purged. Once the pilot is alight, keep the control knob depressed for about 20 seconds. Then release and turn on the main burner. Check that the flame travels easily across the burner and that coal placement does not affect ignition. Re - position coals if required.

Burner Gas pressure

Check burner gas pressure from the test point on the burner supply pipe on the Natural Gas Model and on the injector elbow on the L.P.G. model.

See appliance data badge for pressure settings

Adjust the pressure at the regulator if required.

Check the fire is operating correctly and test for spillage of combustion products

Optional Fan

If a fan has been selected with the fire, it will already be fitted in the firebox at the factory. It is controlled by a wall switch, which should be fitted by an electrician. **There is no switching on the fire and the wall switch is not supplied by Real Fires.**

Fitting Trim to firebox

Fit the Stainless Steel or Black trim to the firebox. The trim brackets are designed to hang over the flange on the front of the firebox. The flange has provision to be moved slightly in or out to allow the bracket to fit. The flange on each side of the firebox has raised square near the base of the fire. The Velcro pad is fixed to this by removing the backing from one side one side of the pad and pushing firmly in place. Then remove the backing from the other side. Repeat on opposite side. Hang trim on brackets and check for level then push firmly onto Velcro pad.

Instruct User

Once the installation is complete, instruct the user on the operation of the fire and complete commissioning details in the Real Fires user manual.

ALL INSTALLATIONS MUST BE CERTIFIED

Installation must meet requirements of NZS5261.

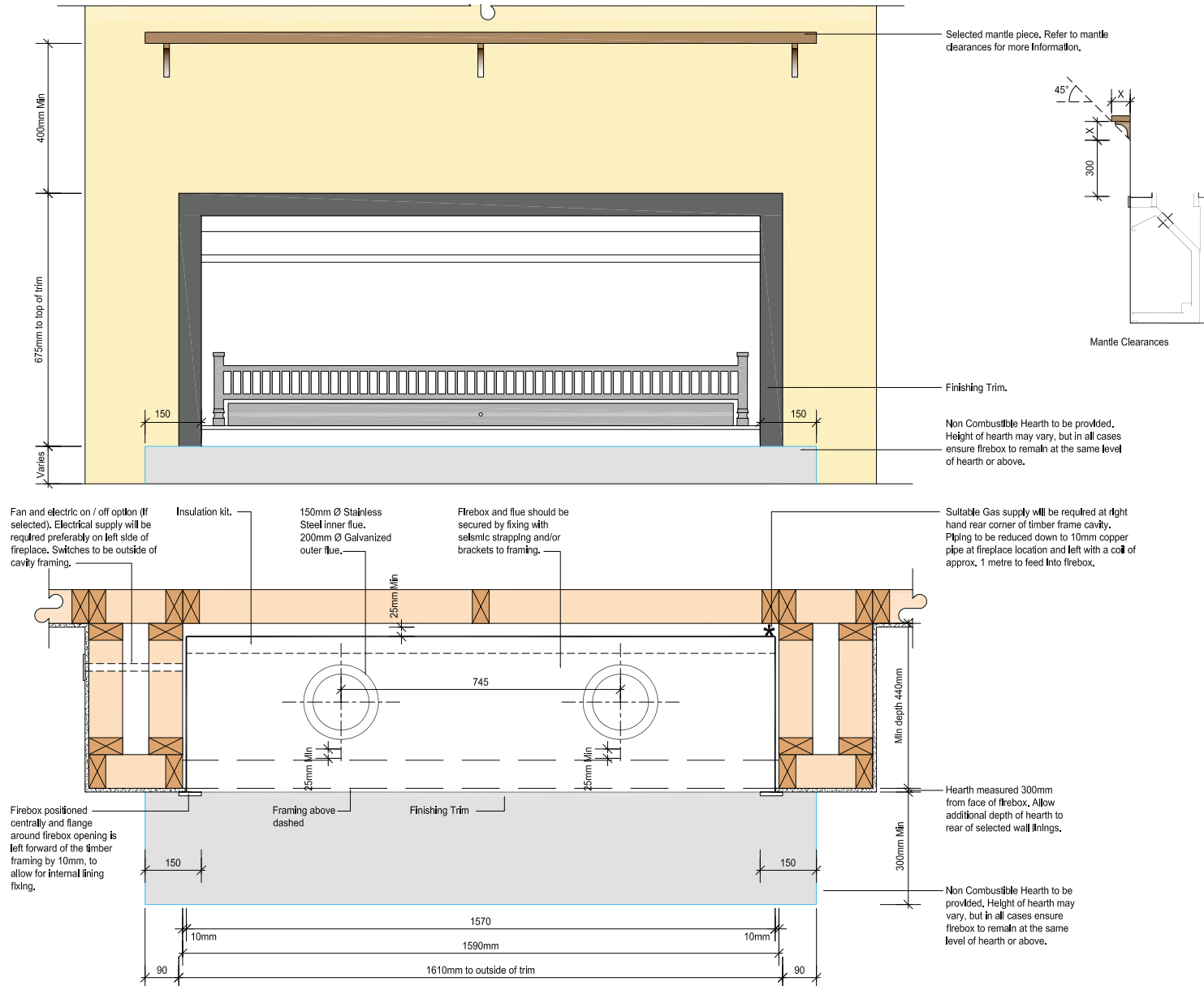

Title: Model RF1500 into Timber Framing				Dwg No:	
Scale: 1:10 @ A3	Date: 01.05.06	Drawn: AD/AD	Rev: -		

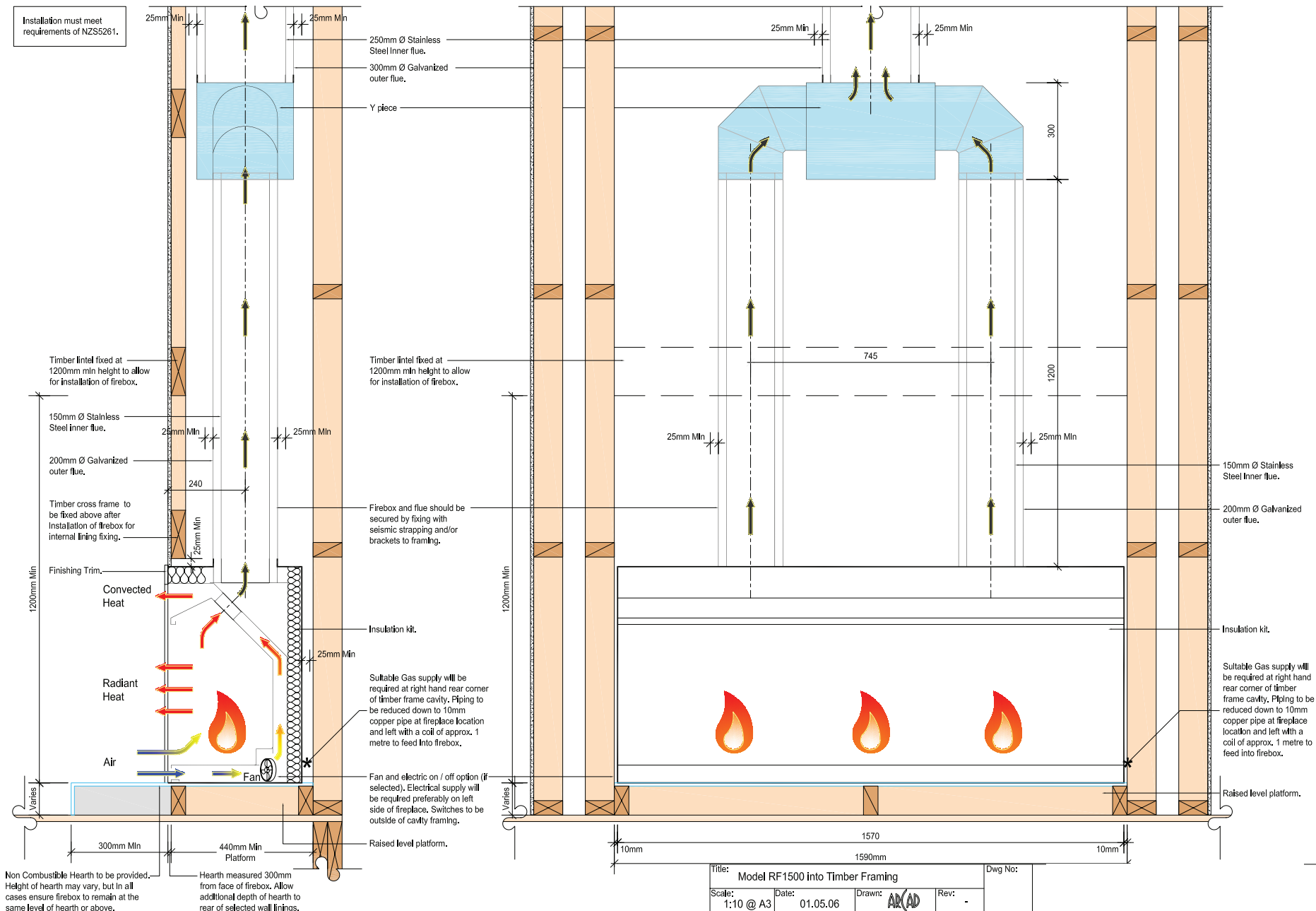

Installation must meet requirements of NZS5261.

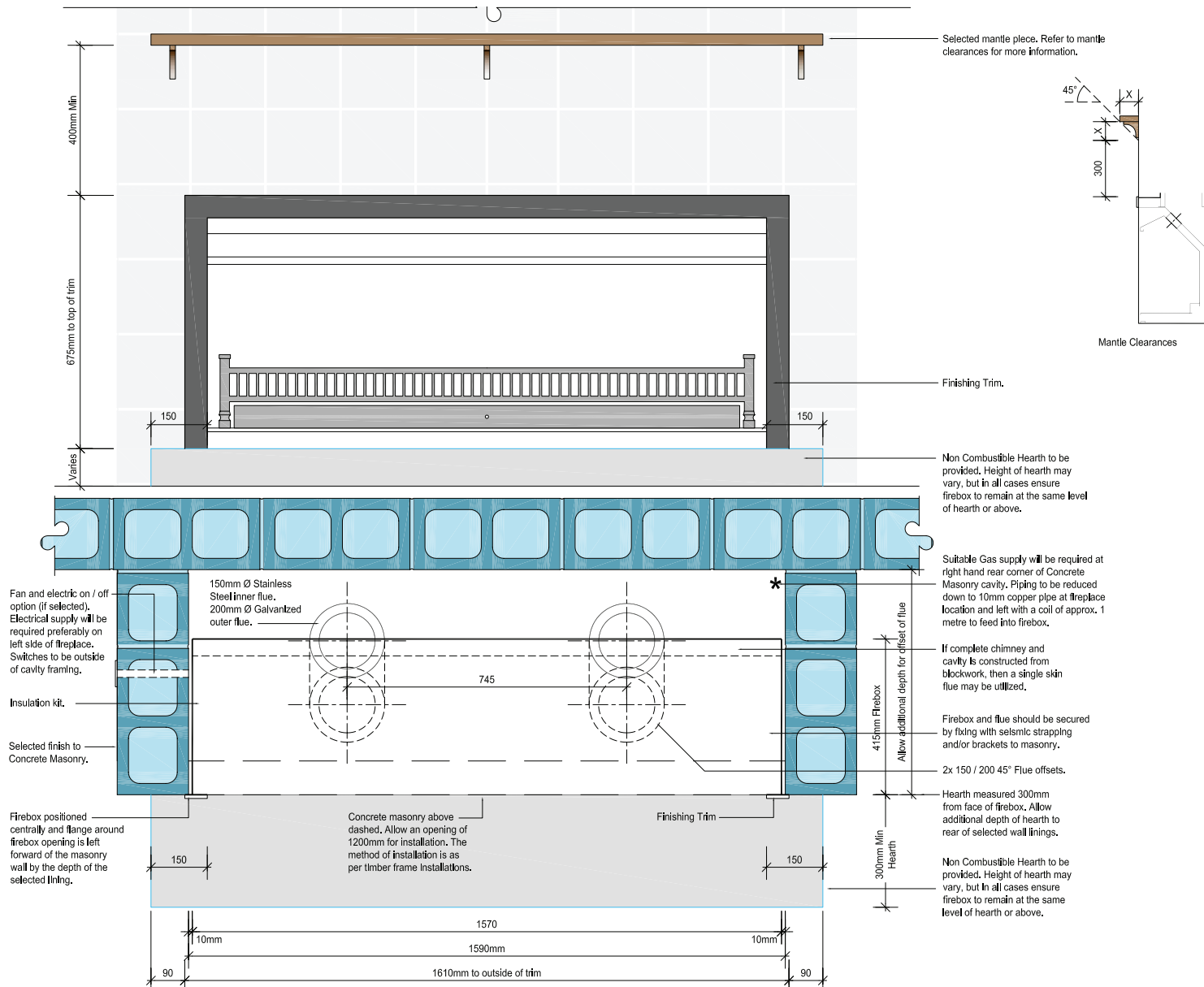

Title: Model RF1500 into New Masonry Block				Dwg No:	
Scale: 1:10 @ A3	Date: 01.05.06	Drawn: AR/AD	Rev: -		

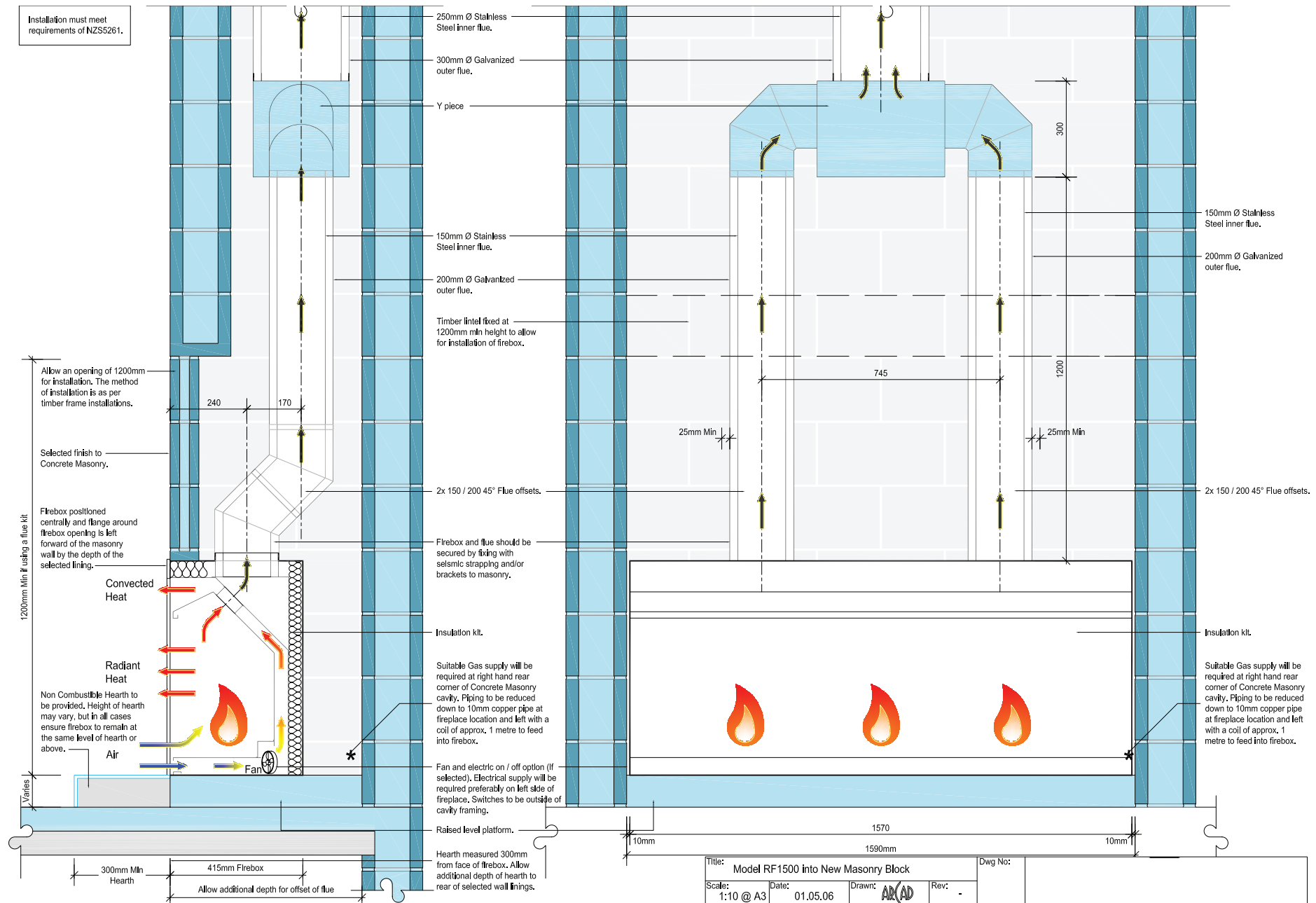

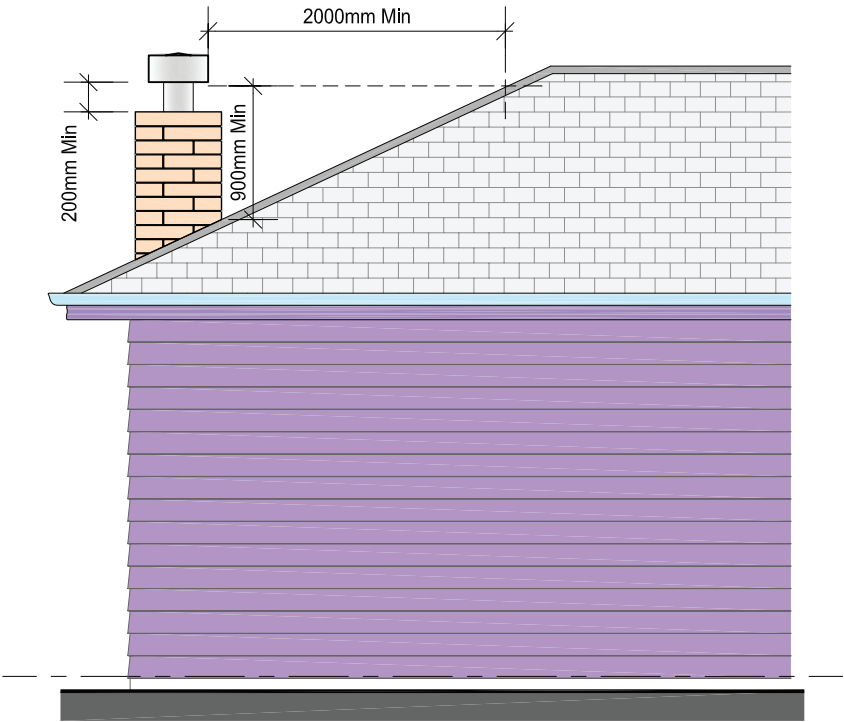
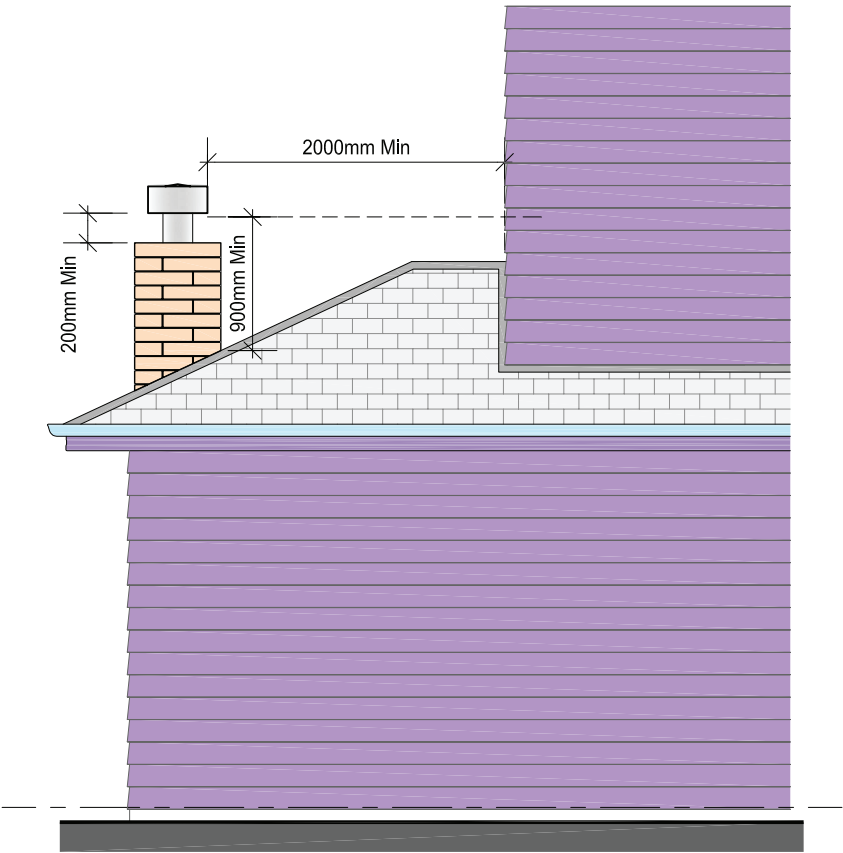

NOTE: The Real Fire gas fireplace flue is required to be 900mm minimum above the roof line and the cowl requires a clearance of 2000mm minimum to all sides.

Title: Real Fires Flue Termination Requirements				Dwg No:
Scale: N.T.S	Date: 01.05.06	Drawn: ARCAD	Rev: -	

Real Fires Log and Coal Layout

This drawing is a typical example of the log and coal layout on a Real Fire 800. The layout is basically the same for all models with logs and coals decreased or increased in width to suit the size of fire. (The pilot ignition assembly has been omitted from the drawing). It is important to ensure that the logs and coals are not too tightly placed as this will affect heat output. Do not place Logs and Coals close to the pilot and ensure that the burner lights easily and flame travels easily across the burner. Reposition if required.

